



INDOOR HEATED AND INSULATED HYDRANT, FOR WAL-MOUNTED, WITH PLACE FOR AN EXTINGUISHER

For indoor use in cold rooms up to -25° such as stocks, food industry buildings, halls, etc.

Thermostatically controlled heating unit and insulation secure cabinet interior against cold. Fire hydrant is not waterproof and is not recommended for outside open area. Hydrant for use inside buildings such as parking lots, warehouses, industrial halls, office buildings, schools, hospitals, kindergartens, sports arenas, cinemas, hotels and conference centers, airports, shopping centers, etc.

Dimensions (width x height x depth) [mm]:

600x825x200

Version:

- For wall-mounting

Implementation:

- Cabinet heated and insulated, made of low carbon steel DC01 with a thickness of min. 1 mm, painted RAL3000 (red) or RAL9010 (white), thickness of layer min. 80 µm
- Inlet holes as knockouts Ø72 mm, 6 connection possibilities
- Insulated hydrant cabinet door with a hinge that allows the door to be opened 180 degrees and a plate that protects the insulation against damage
- Anti-corrosion protection-iron phosphating, epoxy-polyester paint
- Hydrant cabinet insulated with thermal conductivity coefficient insulation material 0,042 W/mk
- 150W/230V thermostatically controlled heating element, IP65 level
- Automatic regulation of the hydrant interior temperature according to the thermostat settings
- Model in a vertical arrangement with additional room for a 4 kg extinguisher

Lack type:

- Yale - mortise Yale lock with a spare key placed on the door panel behind a 1 mm thick glass pane

Equipment:

- Self-locking hose reel for flat hose DN 52, powder coated, color RAL 3000 (red), gloss 80, thickness of layer min. 80 µm
- Winding valve, brass or aluminium DN50 (2") - option
- Fire-hose nozzle PW-52 acc. PN-89/M-51028
- Delivery fire hose, flat H-52 according to PN-87/M-51151 - (15 m or 20 m) and according to EN-694 norm for fire hoses

Working pressure:

- Minimum: 0.2 MPa - maximum: 0.7 MPa

Efficiency:

$P \geq 0.2 \text{ MPa}$ - WSP K = 110 nozzle D13 mm / Q Nom = 150l/min

Marking and documentation:

- Installation instructions
- Marking acc. to EN 671
- The declaration of performance

Conformity to standards and certificates:

- EN 671-2
- EC (CE) certificate of conformity no: 1438/CPR/0005, 1438/CPR/0006, 1438/CPR/0064, 1438/CPR/0065

Options:

- Other cabinet RAL color_____
- Cabinet made of stainless steel 304 or 316L
- Cabinet made in accordance to EN 12944 - corrosion protection level C5
- Hose basket DN52, powder coated, color RAL 3000 (red), gloss 80, thickness of layer min. 80 µm
- Adjustable support legs for freestanding installation on the floor
- Support frame for installation perpendicularly to the wall

Front view

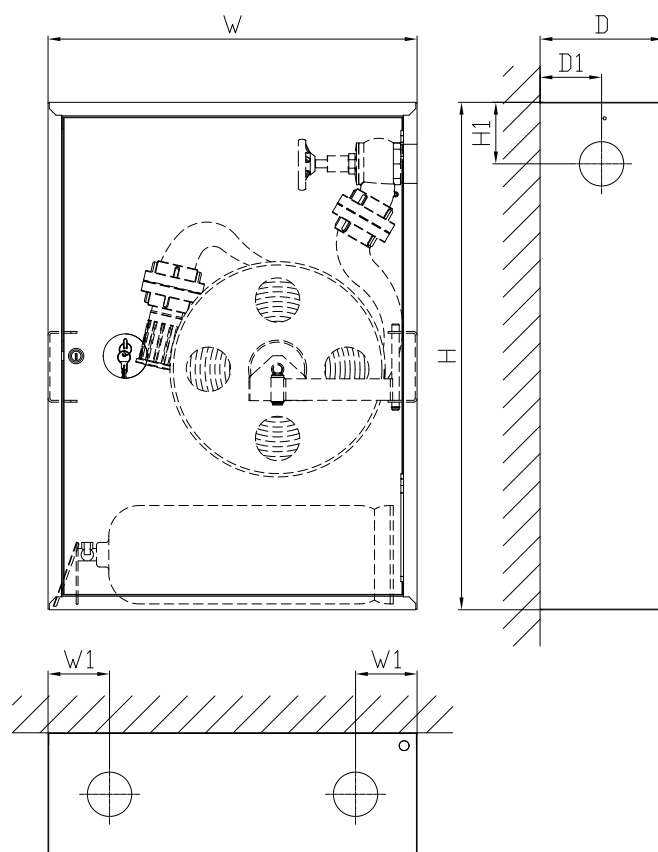

Side view

View from
above

Model	Version	Frame	Hose length [m]		Dimensions [mm]					
			DN50	W	W1	H	H1	D	D1	
HW-52N-KP-20/30 HS	For wall-mounting	-	15 or 20	600	100	825	100	200	100	