



CABINET FOR COLLECTOR 2x75

Cabinet can be made in surface or recessed version. Special rotary, made according to PN-B-02861 (for a light fire axe).

Dimensions (width x height x depth) [mm]:

700x700x300

Version:

- For wall-mounting or for recess-mounting

Implementation:

- Cabinet made of low carbon steel, electrolytically galvanized DC01 with a thickness of min. 0,6 mm, painted RAL3000 (red) or RAL9010 (white),
- Inlet hole Ø110 mm
- Door with 180° opening angle
- Corrosion protection - zinc coating with a thickness of min. 3µm on side
- Universal gras hinge system - right or left hand door (for customer to choose)

Lack type:

- Special rotating type lock, made according to PN-B-02861 (for a light fire axe)

Equipment:

- Siames 2x75 - option

Marking and documentation:

- Installation instructions
- Marking acc. to EN 671

Options:

- Other cabinet RAL color _____
- Cabinet made of stainless steel 304 or 316L
- Cabinet made in accordance to EN 12944 - corrosion protection level C5
- Adjustable masking frames for hydrant installation in a wall recess

Wall-mounted version

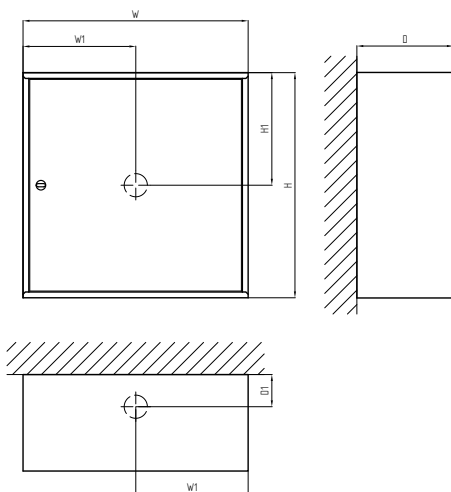

Recess-mounted version

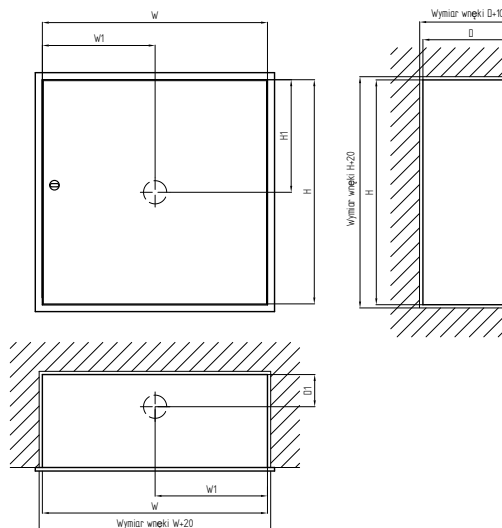

| Model | Version | Ilość zbieraczy [szt.] | Dimensions [mm] | | | | | | |
|-----------|---------------------|------------------------|-----------------|-----|-----|-----|-----|-----|-----|
| | | | DN75 | W | W1 | H | H1 | D | D1 |
| SWSP-N2-D | For wall-mounting | 1 | | 700 | 350 | 700 | 350 | 300 | 100 |
| SWSP-W2-D | For recess-mounting | 1 | | 700 | 350 | 700 | 350 | 300 | 100 |